

Bentley
PONTOONS



At Bentley Pontoons, we believe that the best moments in life are those spent on the water—surrounded by loved ones, immersed in the serenity of nature, and aboard a pontoon that brings both luxury and reliability. Since our inception, we've been dedicated to creating more than just boats. We create gateways to unforgettable experiences.

Our story begins with a passion for bringing people together. Whether it's the laughter of a family fishing trip, the quiet reflection of a sunrise cruise, or the thrill of a watersport adventure, we know that a pontoon is more than a boat—it's a platform for connection. Every detail of our boats are designed with you in mind, so that you can focus on what truly matters: making memories.

Each Bentley Pontoon is built with a commitment to quality, durability, and style. From our state-of-the-art manufacturing process to the fine craftsmanship of every seat, rail, and weld, we put our heart into every boat we build. With a wide array of customizable options, including our signature luxurious interiors and advanced technology, you can create a boat that feels uniquely yours.

But owning a Bentley Pontoon is about more than just style and performance. It's about the moments you'll cherish for a lifetime: the first time your child reels in a fish, the annual sunset cruise with friends, or the spontaneous weekends where you set sail and leave your worries behind. These are the moments we live for, and the ones we strive to create for every Bentley Pontoon owner.

As we continue to innovate and evolve, our core mission remains the same: to design and build pontoons that elevate your experience on the water, crafting boats that make every moment on the water special.

With Bentley Pontoons, the journey is just as extraordinary as the destination. Welcome aboard.

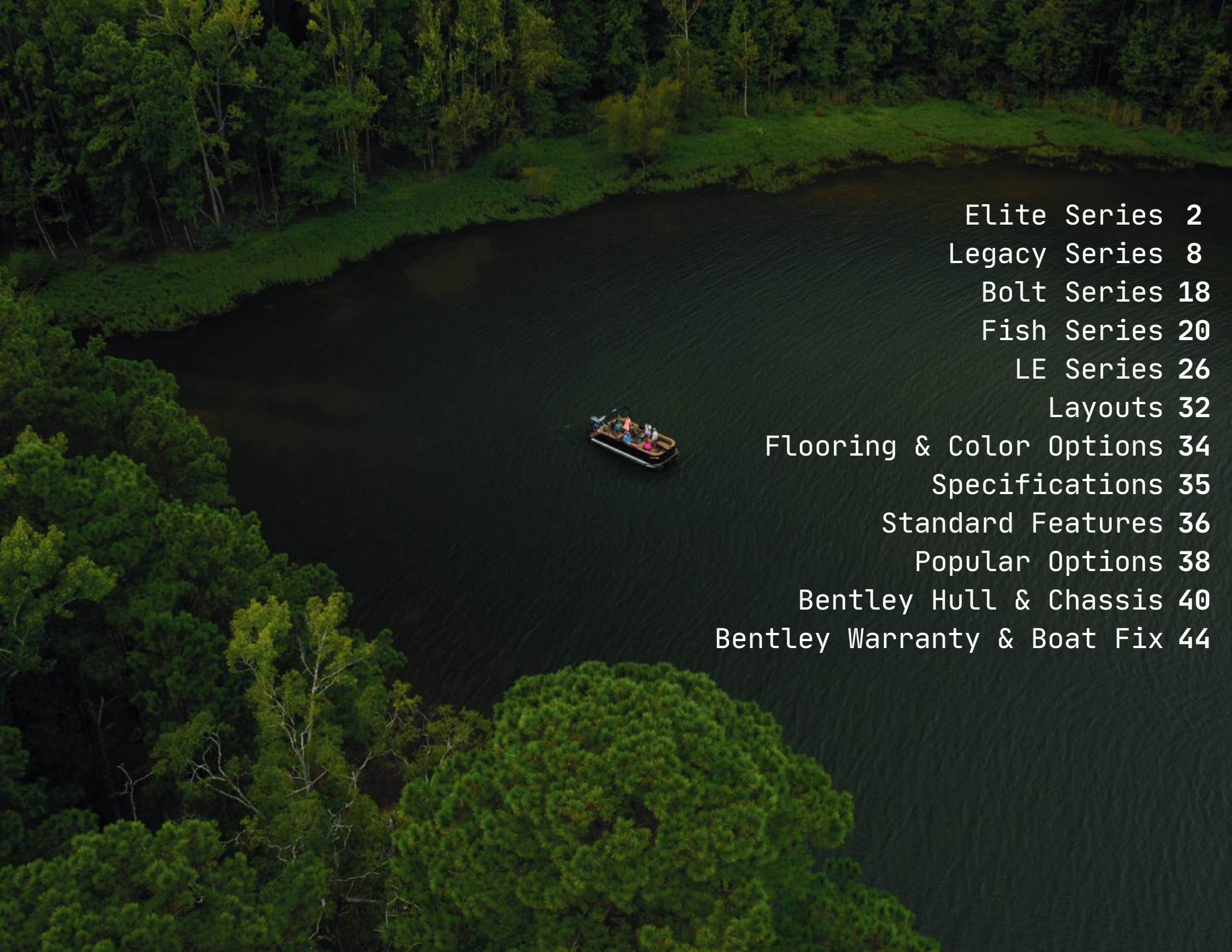
An aerial photograph of a dark-colored pontoon boat with a canopy, floating on a calm lake. The boat is surrounded by dense, lush green forest that covers the shoreline and extends into the water. The water is dark and reflects the surrounding trees.

Elite Series	2
Legacy Series	8
Bolt Series	18
Fish Series	20
LE Series	26
Layouts	32
Flooring & Color Options	34
Specifications	35
Standard Features	36
Popular Options	38
Bentley Hull & Chassis	40
Bentley Warranty & Boat Fix	44

ELITE ADMIRAL



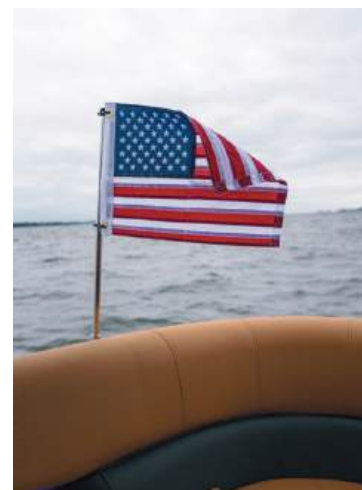

The Elite Admiral floor plan combines luxury and comfort, offering a sleek design and a variety of amenities for an elevated boating experience. Featuring a center walk-thru layout and dual captain's chairs, this model ensures a smooth and enjoyable ride. The extended rear deck provides ample space to relax and soak up the sun, making it the perfect choice for those who value both style and comfort on the water.

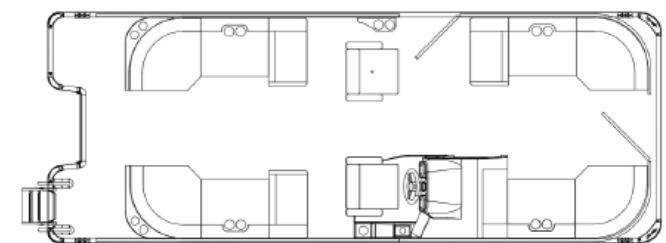

22' Elite Admiral

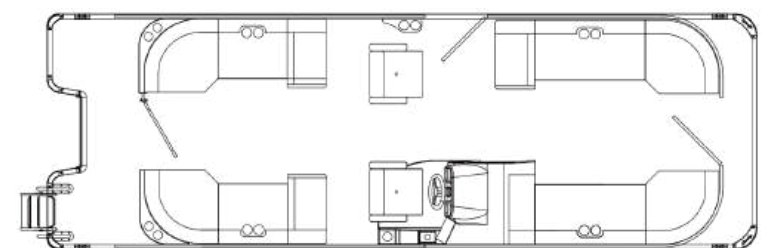

25' Elite Admiral

ELITE SWINGBACK





The Elite Swingback is the pinnacle of luxury and versatility, making it our most sought-after design. Perfectly blending comfort, performance, and style, this layout offers ample seating, a sleek, modern design, and a multi-functional swingback lounge that adapts to your every need. Whether you're cruising with friends, soaking up the sun, or enjoying watersports, the Elite Swingback ensures a premium experience every time you're on the water.

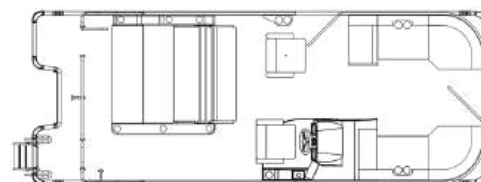

22' Swingback DC

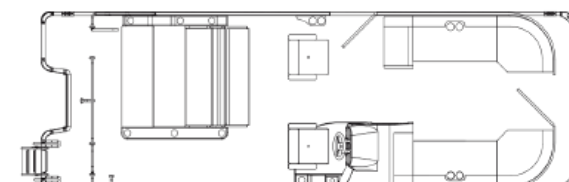

25' Swingback DC

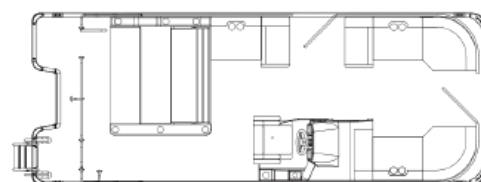

22' Swingback Bench

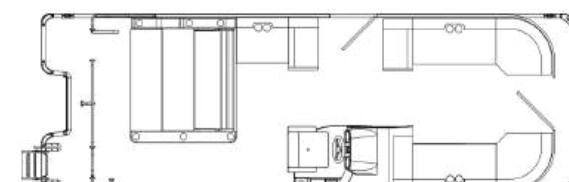

25' Swingback Bench

ELITE QSB





The all-new Elite QSB (Quad Swingback) delivers unmatched versatility on the water. This model features traditional U-shaped seating in the bow, providing ample storage space and convenient amenities like recessed cup holders, plush soft-touch furniture, and dual forward laybacks for ultimate relaxation. The stern includes port and starboard quad swingback seating, allowing for the addition of two standard tables for snacks or entertainment. The adjustable backrest offers the flexibility to face forward or backward, creating a comfortable lounge area to suit any boating experience.

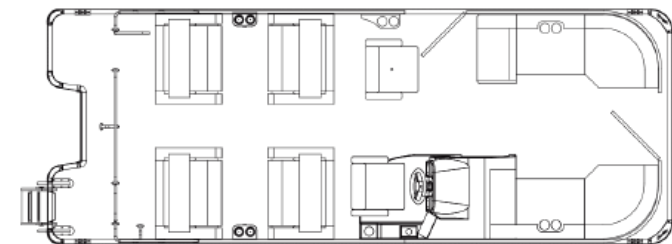

22' Elite QSB

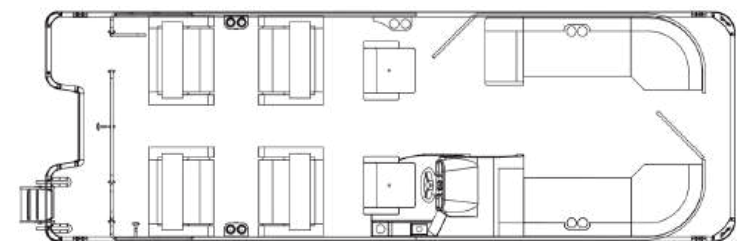

25' Elite QSB

LEGACY QSB





The Legacy QSB (Quad Swingback) floor plan offers the ultimate in boating versatility and comfort. Featuring traditional U-shaped seating in the bow, it provides ample storage, recessed cup holders, and plush soft-touch furniture for maximum relaxation. Dual forward laybacks offer the perfect spot to unwind, while the stern boasts port and starboard quad swingback seating that can be easily adjusted to face forward or backward, transforming into a comfortable lounge. Whether you're entertaining, snacking, or soaking up the sun, the Legacy QSB is designed to enhance every moment on the water.

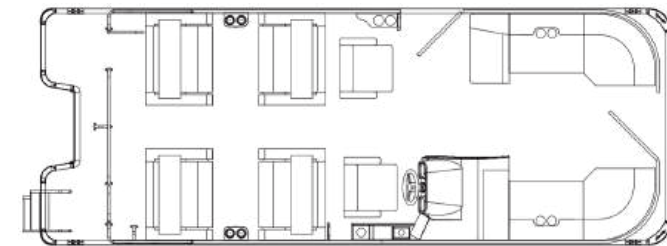

22' Legacy QSB

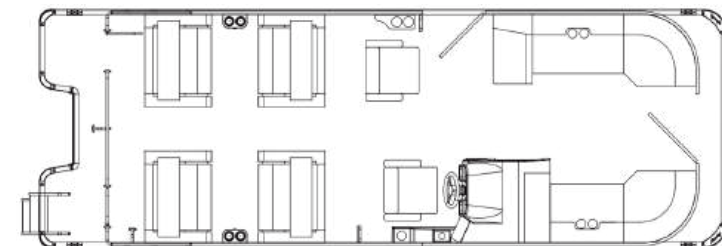

24' Legacy QSB

LEGACY SWINGBACK





The Legacy Swingback floor plan is the perfect choice for those seeking ultimate comfort and versatility on the water. Featuring flexible, multi-directional swingback seating and dual captain's chairs, this layout offers unmatched relaxation and convenience for both the captain and passengers. Ideal for families and friends, the Legacy Swingback ensures everyone can enjoy the ride, whether you're cruising, lounging, or simply enjoying the view. Designed for effortless enjoyment, it's the perfect blend of luxury and functionality for your next adventure.

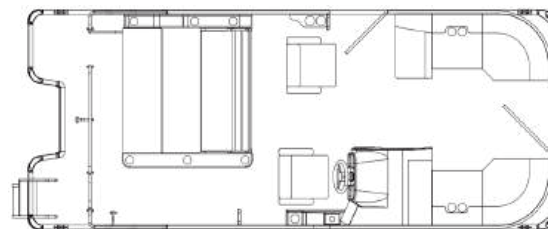

20' Legacy Swingback

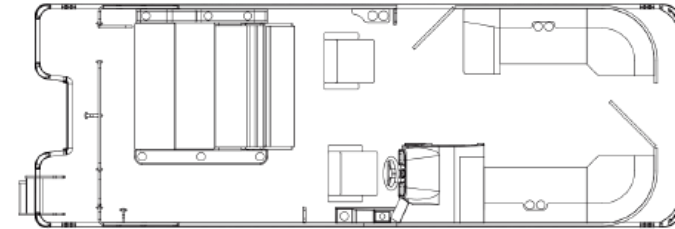

24' Legacy Swingback

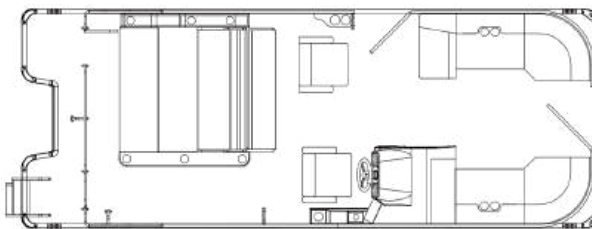

22' Legacy Swingback

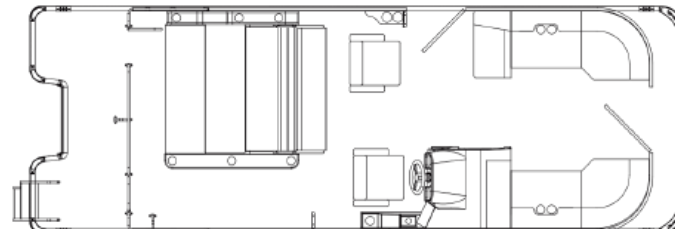

24' Legacy Swingback EXT

LEGACY NAVIGATOR





The Legacy Navigator features a timeless center walk-thru floor plan, dual captain's chairs, and an extended rear deck for maximum space and comfort. Designed for unmatched performance, enhanced style, and superior craftsmanship, the Navigator makes every outing effortless. With this model, you'll cruise the waters with ease while enjoying all the fun and adventure it brings.

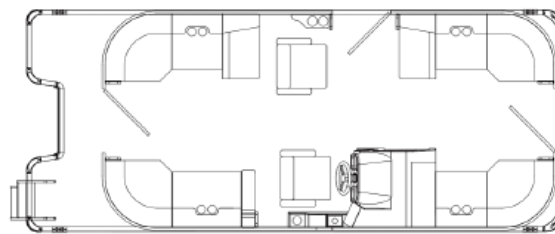

20' Legacy Navigator

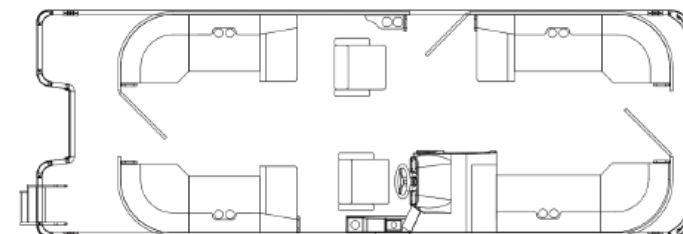

24' Legacy Navigator

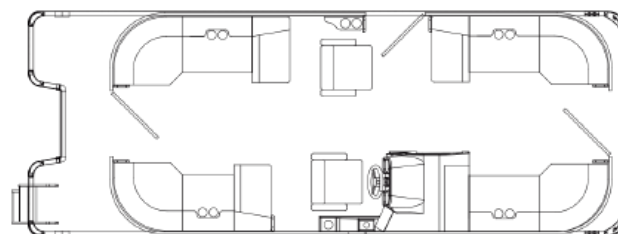

22' Legacy Navigator

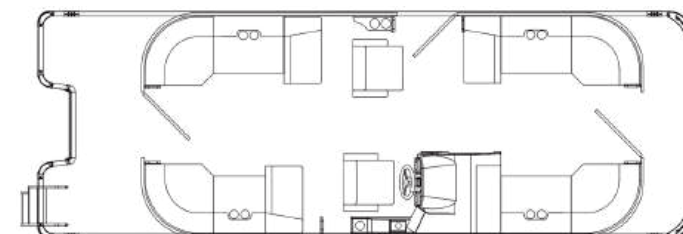

24' Legacy Navigator EXT

LEGACY CRUISE





For the ultimate cruising experience, step aboard the Legacy Cruise. Featuring classic rear "L" section seating, generous storage, and a spacious sun deck, this model offers luxury and comfort on the water. Discover the unmatched quality and craftsmanship that Bentley Pontoons is known for and enjoy every moment on the water.

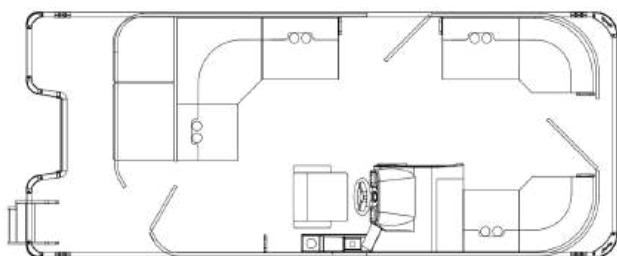

20' Legacy Cruise

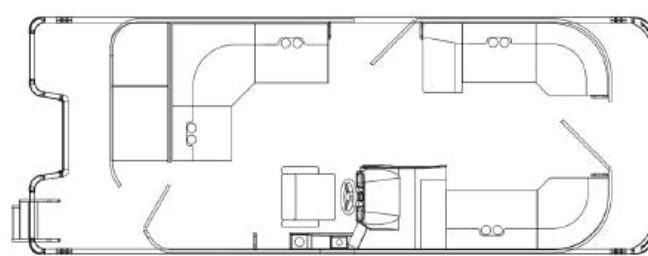

22' Legacy Cruise

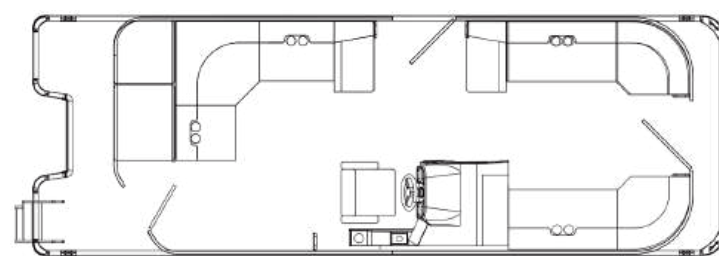

24' Legacy Cruise

LEGACY CRUISE XL





Featuring an extended rear deck and a classic floor plan, the Legacy Cruise XL is the ideal pontoon for a relaxing day on the water. The Cruise XL models deliver exceptional performance, refined style, and superior craftsmanship. Experience a new level of cruising comfort and enjoyment.

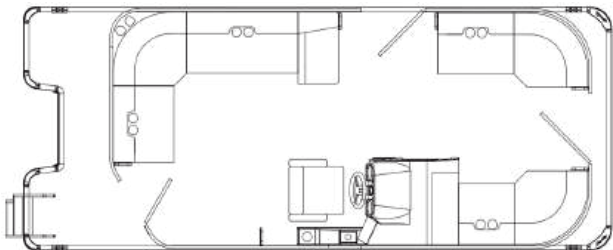

20' Legacy Cruise XL

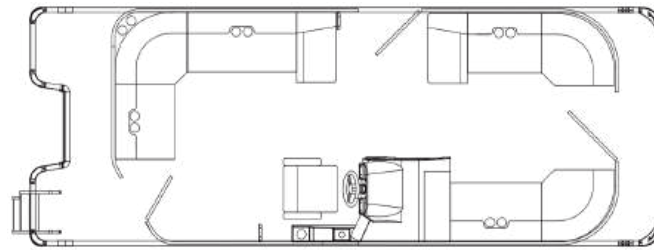

22' Legacy Cruise XL

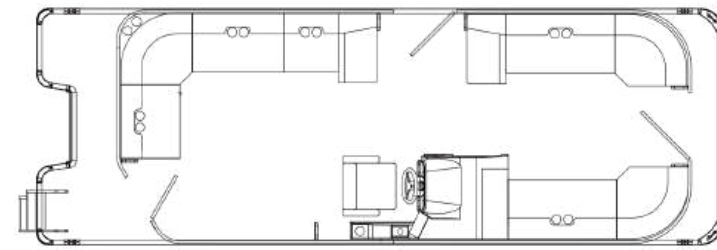

24' Legacy Cruise XL

BOLT



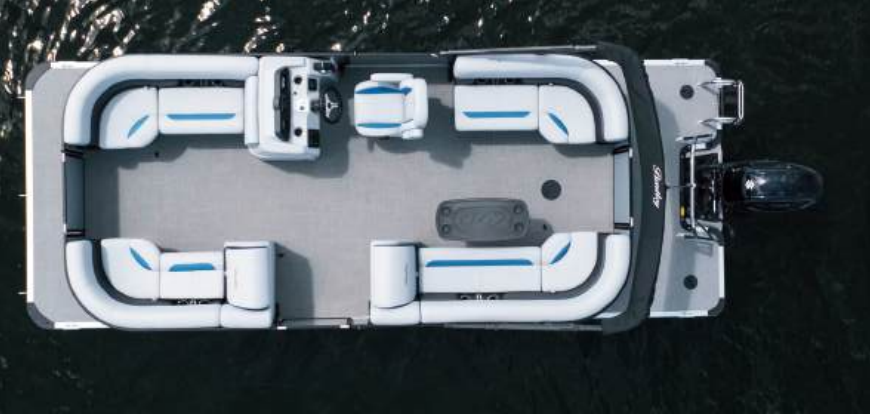

The Bentley Bolt is the perfect pontoon boat for water enthusiasts seeking an affordable and sporty adventure. This brand-new SPORT3 delivers an unexpectedly exhilarating ride on the water, with a top speed in the mid 40's. The Bolt models provide enhanced maneuverability, due to the added lifting strakes which also ensures a smooth and controlled experience even at high speeds.

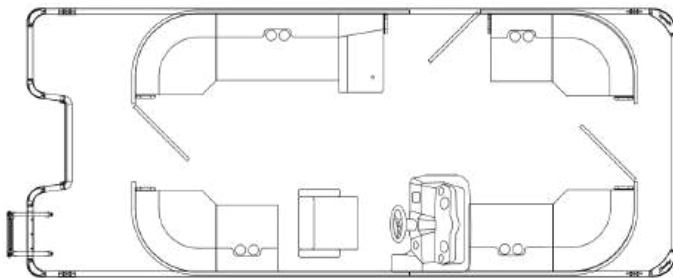

20' Bolt

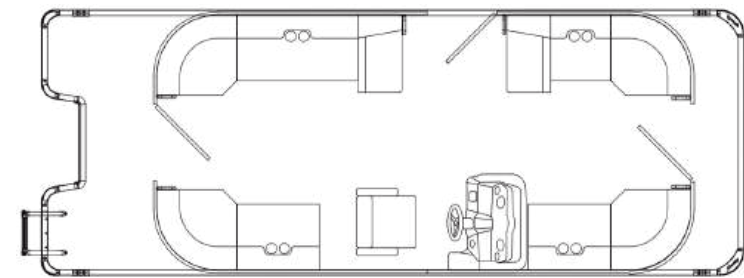

22' Bolt

FISH CENTER WALK-THRU





Prepare for any adventure with the innovative Forward Fish models featuring a Center Walk-Thru floor plan. Enjoy the best of both worlds with a fishing setup in the front and an "L" section in the stern. Whether you're fishing, cruising, or simply relaxing, this layout provides plenty of space to suit all your needs.

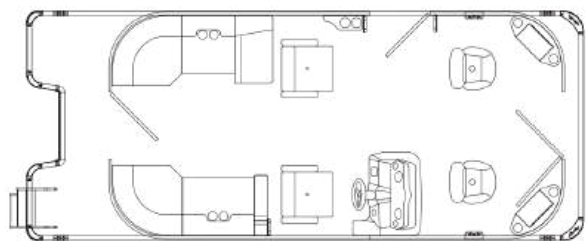

20' FISH CW

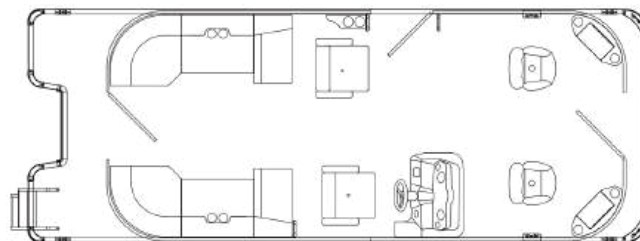

22' FISH CW

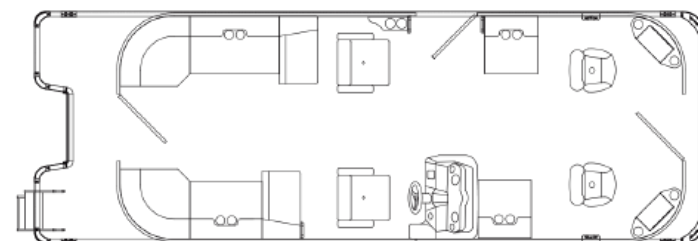

24' FISH CW

FISH-N-CRUISE



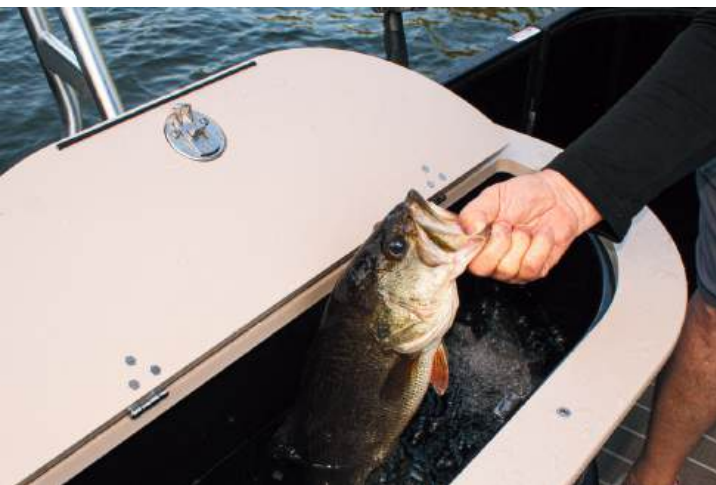

The Fish-N-Cruise is perfect for both a day of fishing and a leisurely cruise. Featuring a Cruise front end and “L” section, along with two rear fishing seats and an aft bait station, this floor plan offers the best of both worlds. With plenty of space for fishing, cruising, and relaxation, it's designed to suit any occasion on the water.

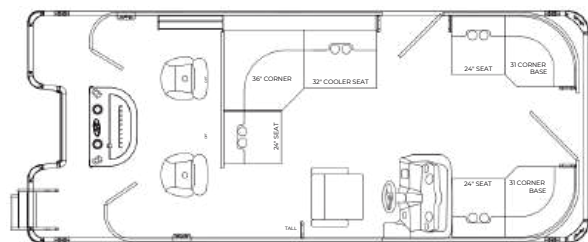

20' FISH-N-CRUISE

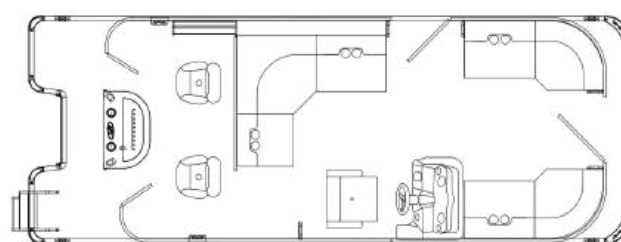

22' FISH-N-CRUISE

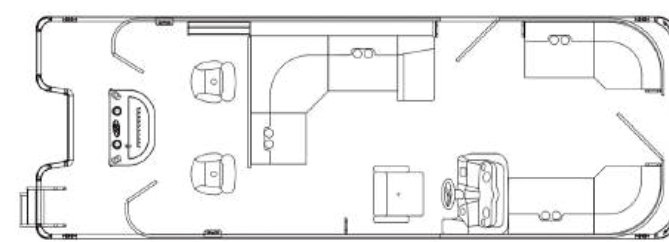

24' FISH-N-CRUISE

FISH 4-POINT





Designed for the avid angler, the 4-Point Fish boat features a traditional "L" seating arrangement with fishing seats at all four corners, providing excellent access to the water. The spacious and comfortable seating, combined with an open floor plan, allows for easy movement around the boat, making it ideal for long days spent fishing on the water.

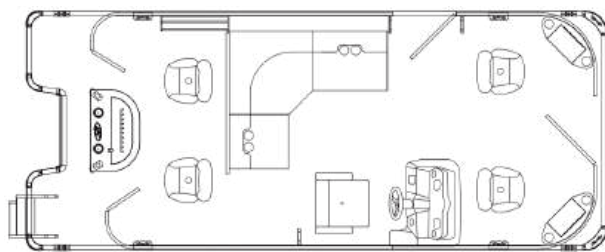

20' FISH 4-POINT

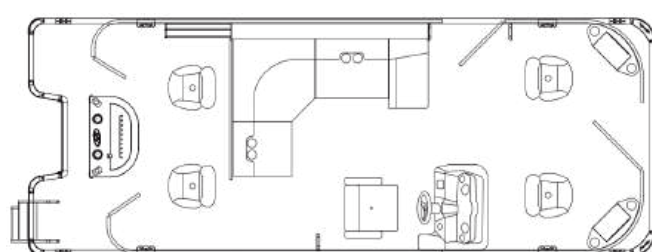

22' FISH 4-POINT

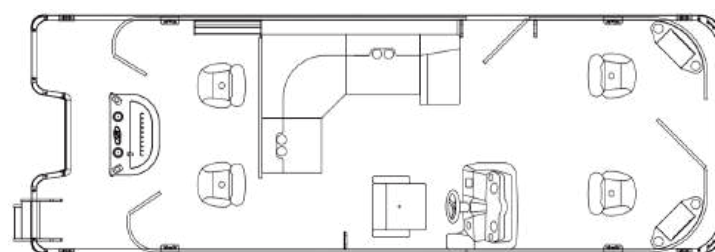

24' FISH 4-POINT

LE CENTER WALK-THRU





Whether you're enjoying a day with family or friends, the LE Center Walk-Thru is an excellent choice for a fun-filled outing on the water. These versatile pontoons are perfect for cruising the lake or relaxing at the sandbar. Packed with features, this boat promises endless entertainment for everyone onboard.

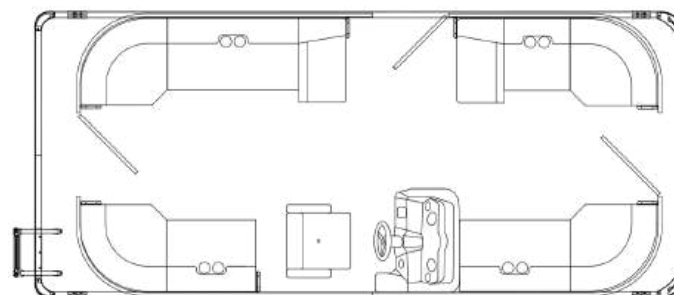

20' LE CW

LE CRUISE



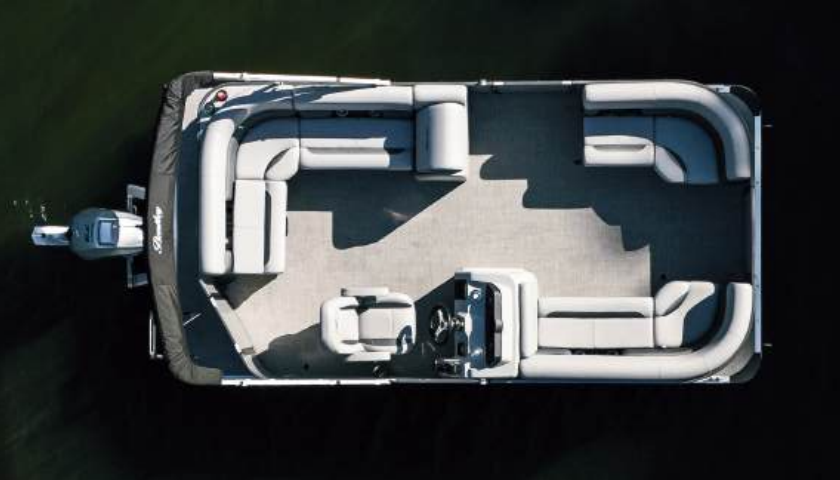

The LE CR (Cruise) is the perfect choice for a fun-filled family day on the water. With its compact design and superior quality, this boat offers everything you need for a memorable day with loved ones. Whether you're taking the kids fishing or relaxing at the sandbar, the LE CR provides comfort, versatility, and durability. It's the ideal balance of function and style, designed to make every family outing effortless and enjoyable.

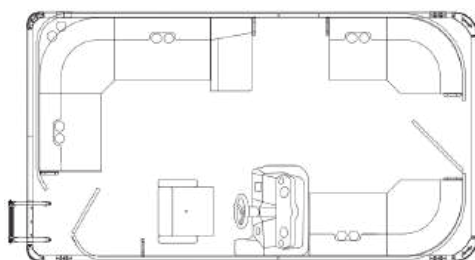

16' LE CR

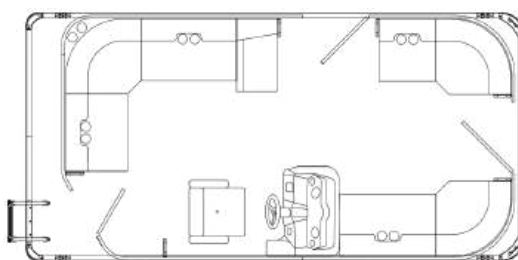

18' LE CR

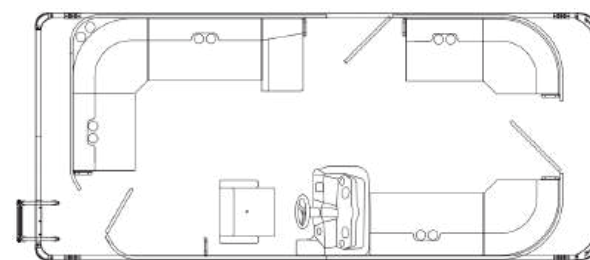

20' LE CR

LE 3-POINT





If you're seeking a pontoon that offers excitement for both cruising on the lake and anchoring at the sandbar, the LE 3-Point is the perfect choice. This highly versatile pontoon is ideal for those looking for a compact fishing boat, a leisurely lake cruiser, or a fun day at the sandbar.

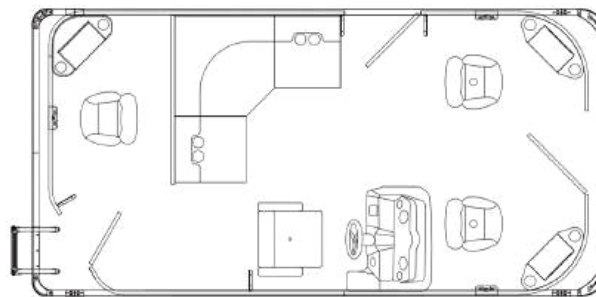

18' LE 3-POINT

Elite Layouts

22' Models

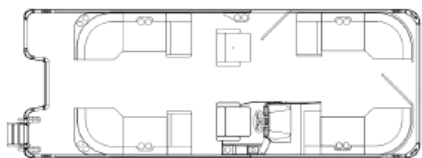

22' Admiral

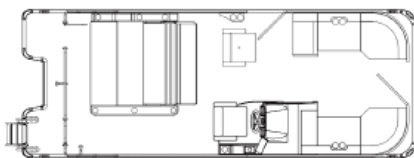

22' Swingback Dual Captain

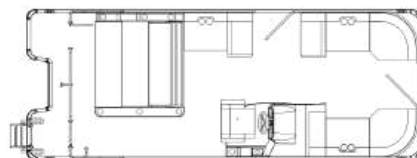

22' Swingback Bench

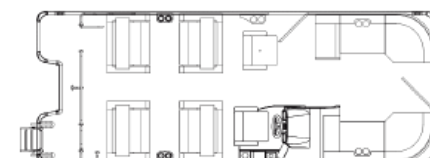

22' QSB

25' Models



25' Admiral

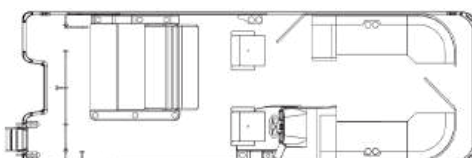

25' Swingback Dual Captain

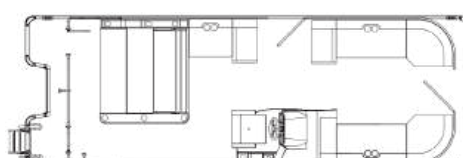

25' Swingback Bench

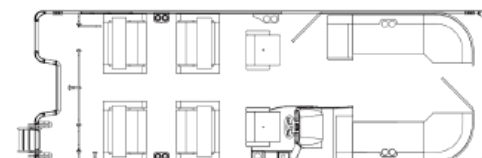

25' QSB

Fish Layouts

20' Models



20' FWD FISH CW

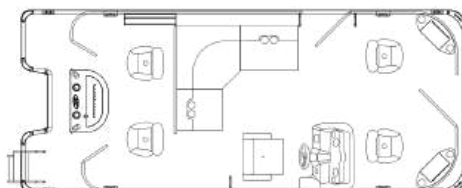

20' 4-POINT



20' FNC

22' Models

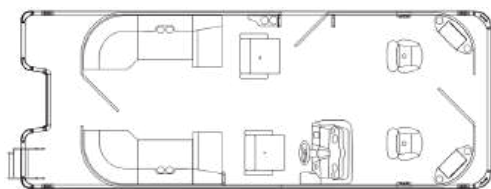

22' FWD FISH CW

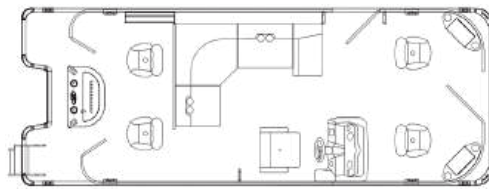

22' 4-POINT

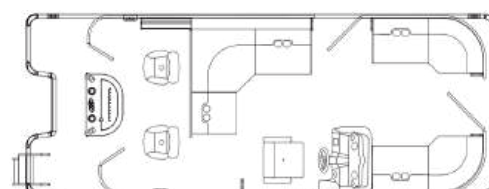

22' FNC

24' Models

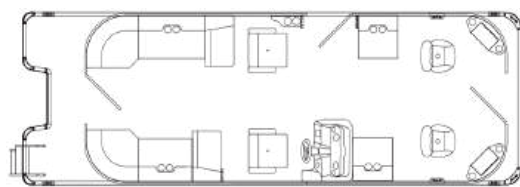

24' FWD FISH CW

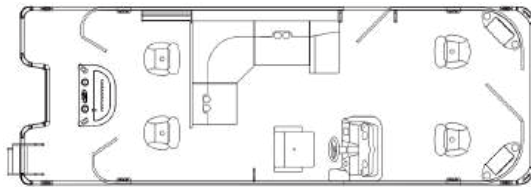

24' 4-POINT

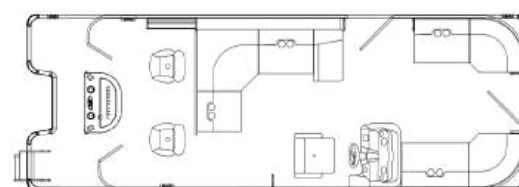

24' FNC

Legacy Layouts

20' Models



20' Navigator

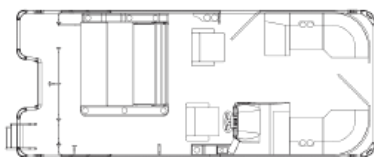

20' Swingback



20' Cruise



20' Cruise XL

22' Models

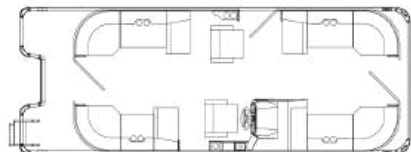

22' Navigator

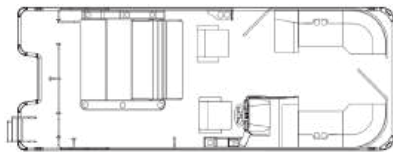

22' Swingback

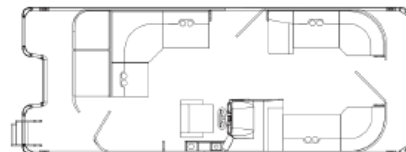

22' Cruise



22' Cruise XL



22' QSB

24' Models



24' Navigator

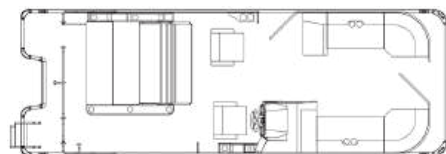

24' Swingback



24' Cruise

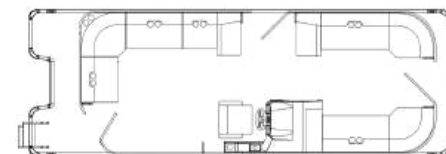

24' Cruise XL

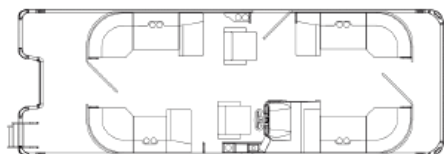

24' Navigator EXT

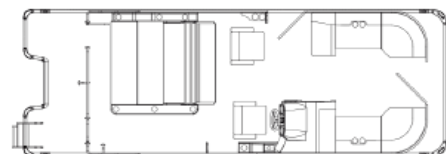

24' Swingback EXT



24' QSB

*Product specifications are subject to change without notice

Bolt Layouts

Color Options

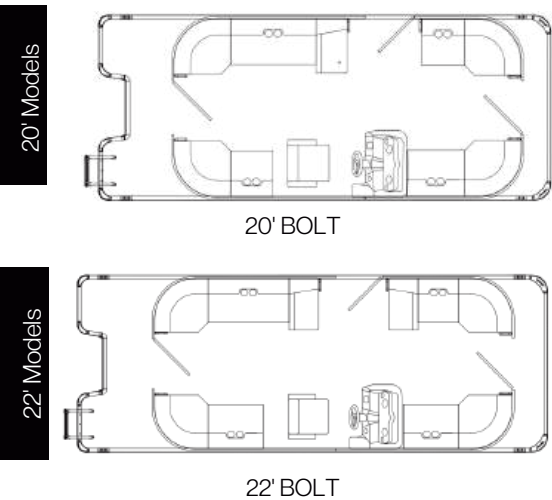

*Indicates accent panel option only

LE Layouts

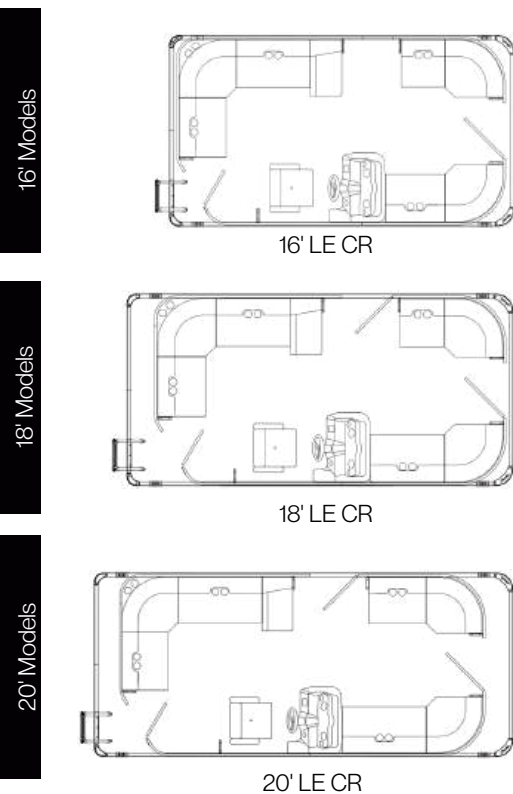

Floor Covering Options



Specifications

MODEL	Pontoon Diameter	Pontoon Gauge	BEAM	Fuel Capacity (Gal)	Overall Length (No Engine)	Pontoon Length	Deck Length (*= Ext Deck Model)	Approximate Dry Weight (No Engine)	Person Capacity	Max LBS	Shaft Motor	Max HP
LE SERIES												
LE 160	25"	0.080	8'6"	18	16'11"	16	15	1540	7	1190	20"	50
LE 180	25"	0.080	8'6"	18	18' 4"	17' 10"	17' 1"	1580	8	1360	20"	75
LE 200	25"	0.080	8'6"	18	20' 8"	20'	19' 5"	1850	11	1870	20"	90
FISH SERIES												
Fish 200	25"	0.080	8'6"	32	20' 8"	20'	19' 5"	1860	12	2040	20"	115
Fish 203 (SPORT3)	25"	0.080	8'6"	32	20' 8"	20'	19' 5"	2160	12	2040	20"	150
Fish 220	25"	0.080	8'6"	32	22' 8"	22'	21' 6"	2180	12	2040	20"	150
Fish 223 (SPORT3)	25"	0.080	8'6"	32	22' 8"	22'	21' 6"	2480	12	2040	20"	200
Fish 223 (XLP3)	25"	0.080	8'6"	54	22' 8"	22'	21' 6"	2680	15	2550	25"	250
Fish 240	25"	0.080	8'6"	32	24' 8"	24'	23' 5"	2180	14	2380	20"	150
Fish 243 (SPORT3)	25"	0.080	8'6"	32	24' 8"	24'	23' 5"	2480	14	2380	20"	250
Fish 243 (XLP3)	25"	0.080	8'6"	54	24' 8"	24'	23' 5"	2740	16	2720	25"	250
LEGACY SERIES												
Legacy 200	25"	0.080	8'6"	32	20' 8"	20'	20'8"	1900	14	2380	20"	115
Legacy 203 (SPORT3)	25"	0.080	8'6"	32	20' 8"	20'	20'8"	2200	14	2380	20"	150
Legacy 220	25"	0.080	8'6"	32	22' 8"	22'	22' 8"	2180	15	2550	20"	150
Legacy 223 (SPORT3)	25"	0.080	8'6"	32	22' 8"	22'	22' 8"	2480	15	2550	20"	200
Legacy 223 (XLP3)	25"	0.080	8'6"	54	23' 2"	22'	22' 8"	2680	15	2550	25"	250
Legacy 240	25"	0.080	8'6"	32	24' 8"	24'	24' 8"	2240	16	2720	20"	150
Legacy 243 (SPORT3)	25"	0.080	8'6"	32	24' 8"	24'	24' 8"	2540	16	2720	20"	250
Legacy 243 (XLP3)	25"	0.080	8'6"	54	25' 2"	24'	24' 8"	2740	16	2720	25"	300
BOLT SERIES												
Bolt 203 (SPORT3)	25"	0.080	8'6"	32	20'8"	20'	20'8"	2080	9	1951	20"	150
Bolt 223 (SPORT3)	25"	0.080	8'6"	32	22'8"	22'	22'8"	2340	12	2205	20"	150
ELITE SERIES												
Elite 220	25"	0.080	8'6"	32	22' 8"	22'	*22' 8"	2280	15	2550	20"	150
Elite 223 (SPORT3)	25"	0.080	8'6"	32	22' 8"	22'	*22' 8"	2580	15	2550	20"	200
Elite 223 (XLP3)	25"	0.080	8'6"	54	23' 2"	22'	*22' 8"	2780	15	2550	25"	250
Elite 250	25"	0.080	8'6"	32	25' 8"	25'	*25' 8"	2560	16	2720	20"	175
Elite 253 (SPORT3)	25"	0.080	8'6"	32	25' 8"	25'	*25' 8"	2860	16	2720	20"	250
Elite 253 (XLP3)	25"	0.080	8'6"	54	26' 3"	25'	*25' 8"	3060	16	2720	25"	350

*Product specifications are subject to change without notice, refer to website for most current information.

*All capacities are USA only

2025 Standard Features

2025 Standard Features	LE Series	Fish Series	Bolt Series	Legacy Series	Elite Series
5-Year Bow to Stern Warranty (Limited)	•	•	•	•	•
Bentley 24/7 Customer Assurance	•	•	•	•	•
3/4" - 7 Ply Marine Grade Plywood W/ Lifetime Warranty	•	•	•	•	•
25" Diameter Tubes W/ Lifetime Warranty (Workmanship)	•	•	•	•	•
5/8" Full Solid Keel	•	•	•	•	•
All Welded Aluminum Transom w/Built-In Fuel Tank w/ Lifetime Warranty (Workmanship)	•	•	•	•	•
Composite Built in Fuel Tank Size (Gallons)	18	32/52**	32	32/52**	32/52**
.190 Hat Channel Crossmembers at Motor Pod Area		•	•	•	•
Powder Coat Railing	•	•	•	•	•
Custom Fiberglass Console	•	•	•	•	•
OEM Analogue Gauges	•	•		•	
OEM Digital Multi-Function Gauge			•		•
Speedometer, Tachometer, Voltage & Fuel	•	•	•	•	•
Dual Simrad NSX7 With OEM Gauge Interface					•
Switchpanel W/ Easy Access Resettable Breakers	•	•	•	•	•
Stereo System	JBL JAM3000	JBL JAM3000	JBL JAM3000	JBL JAM3000	Rockford PMX2
# Speakers	4	4	4	4	6
12 Volt Receptacle w/ Dual USB Charging Ports	•	•	•	•	•

**32 gallon tank standard on 3/4 tube models, 52 gallon tank standard on full third center models.

*Product specifications are subject to change without notice, refer to website for most current information.

2025 Standard Features

2025 Standard Features	LE Series	Fish Series	Bolt Series	Legacy Series	Elite Series
LED Navigation Lights & LED Docking Lights	•	•	•	•	•
Sealed "Deutsch" Style Electrical Connectors	•	•	•	•	•
Seastar Extreme Mechanical Steering W/ Tilt	•	•		•	
Seastar Hydraulic Steering W/ Tilt		Opt.	•	Opt.	•
10' Bimini w/ Quick Disconnect	•	•	•	•	•
Rotocast Furniture W/ Integrated Cupholders	•	•	•	•	•
Deluxe Highback Captains Chairs		Opt.		Opt.	•
Premium Furniture W/ Upholstered Bases					•
Bentley Premium Radius Wide-Step Aluminum Ladder	SS Telescopic	•	SS Telescopic	•	
Lillipad REVO Ladder (Black Powder Coat)		Opt.		Opt.	•
Stainless Steel Flip-Up Cleats		Opt.		Opt.	•
Fishing Chairs		•			
Built-in Livewell		•		Opt.	
Table W/ Cupholders	•	•	Opt.	•	•
Standard Flooring	Seagrass	Seagrass/ Vinyl	Seagrass	Seagrass	Seagrass
Bumper Guard W/ Rubber Insert	•	•	•	•	•
Standard Helm Seating	Midback	Midback	Midback	Midback	DLX Highback

*Product specifications are subject to change without notice, refer to website for most current information.

Popular Options



Aluminum Ski Tow Bar



Power Arm Electric Bimini



Highback Chair



Flip Up Cleat



Lifting Strakes



EZ View Bow Gate



Ski Locker Storage



Aluminum Underskin



Accent Panels



Legacy Raised Helm



Simrad NSX7



Humminbird Helix 5



Exterior Blue LED Lights



Interior Blue LED Lights



Rockford Stereo System



Wet Sounds Premium Package

Popular Options



Wood Grain Table



Windshield



SS Telescoping Ladder



LilliPad revo ladder



Furniture Cover



Lounge End Flip Up Table



Dog Bowl



Under Helm Cooler Slide



Black Bimini Frame



Playpen Cover



Changing Room



Drop Down Changing Room



Dual Bimini



Fender Pros



SS Rail Mounted Flag Holder W/ USA Flag



Wireless Charger W/ USBs Package

The Bentley Hull and Chassis

Your foundation for quality, comfort, performance and handling

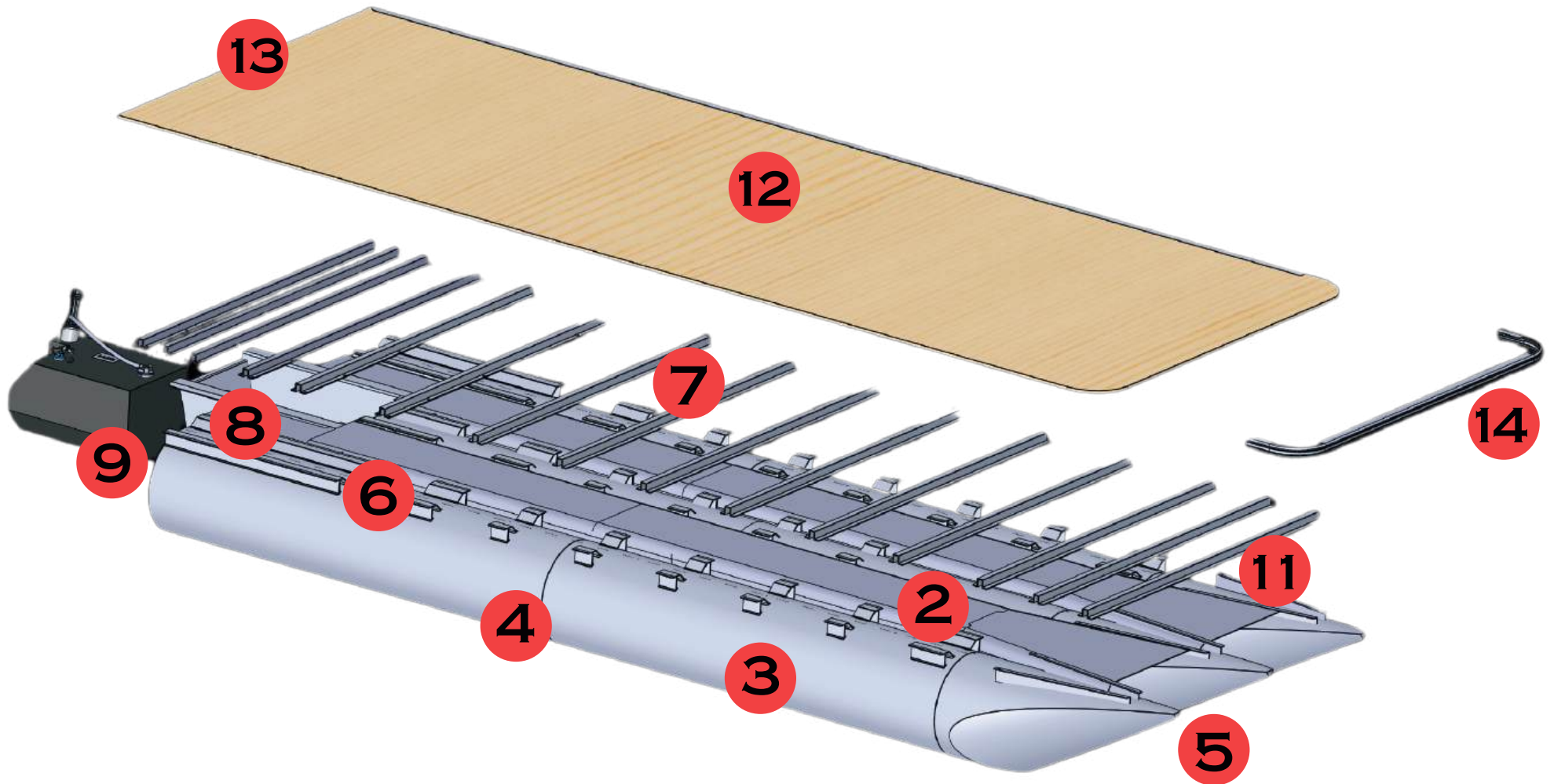

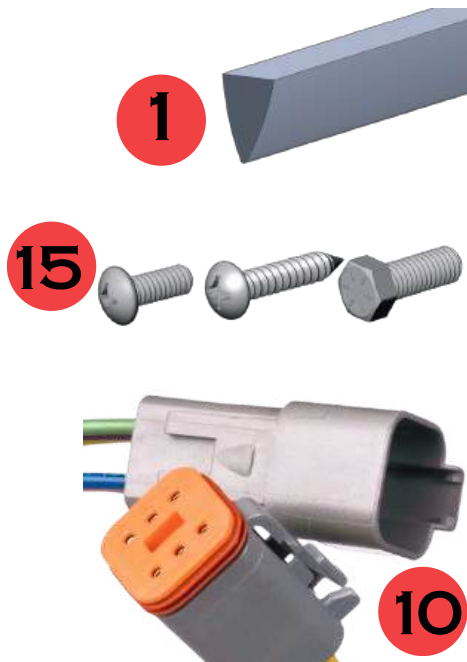

Bentley designed our .125 or .190 "hat" channel with two support bolts. Butyl tape is applied to seams for added waterproofing.

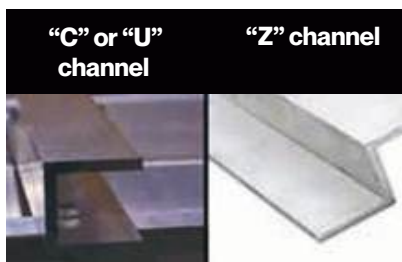

What Bentley's Competitors use

Inferior shaped and engineered crossmember or cross channel utilizing only one support bolt.

Item	Feature	Feature Details
1	Keel	All our tubes feature a 5/8" full length, solid keel.
2	Tube diameter and thickness	25" diameter tubes are constructed from .080 thick aluminum sheet
3	Lifting strakes or performance lifting strakes	.100 thick aluminum lifting strakes are optional on 2-tube hulls and standard on 3-tube hulls. Our lifting strakes are strategically placed on the tube and hydrodynamically designed to create "lift" which reduces drag, increases speed and improves maneuverability.
4	Tube baffles	Each joint of the tube has a baffle for added strength. The baffle has a drain hole for servcability.
5	Nose cones	All our nose cones have splash fins along with a proprietary keel for added strength and rigidity.
6	Cross member risers	It is important for all chassis to flex, but remain solid and intact. For this reason, the Bentley chassis uses multi-length "M" bracket risers, strategically placed and welded to the tube, for added strength.
7	Cross members	.190 thick aluminum extruded "hat" channel cross members are used in the stern and .125 aluminum extruded elsewhere.
8	Transom and motor pod	Our boats have an all welded, aluminum transom, which utilizes .190 aluminum sheet in the motor pod area for maximum strength. * excluding LE models
9	Fuel tanks	All Bentley fuel tanks are roto-molded for maximum quality and fitment. They are mounted in the motor pod area and are diurnal EPA certified.
10	Wiring and harnesses	Deutsch-style electrical connectors are used to ensure quality.
11	Aluminum underskin	.063 thick aluminum sheet is fastened, using marine grade stainless steel rivets, to the underside of the decking/cross members. This underskin helps to reduce turbulence, noise, spray and increase speed.
12	Decking	3/4"-7-Ply marine grade plywood is used for the decking material.
13	Beam	Every Bentley chassis features a 8'6" beam. This is the maximum width allowed for towing a boat without a special permit.
14	Rub rail	All our boats come standard with a rubber insert engineered into the rub rail.
15	Hardware	100% of all nuts, bolts and fasteners on the chassis are stainless steel.

Tailor your boating experience by choosing a hull and options that are engineered to fit your unique style.

At Bentley, we believe that you should be in control of your boating experience. That's why we offer a variety of hull options that can be tailored to meet your unique preferences. You have the flexibility to choose the features that are best suited for your needs and budget. Although there are some limitations, the possibilities are endless – and we know you love having options.

Did you know that over 50% of our customers prefer our three-tube hulls? However, don't let that statistic fool you – our two-tube hulls perform just as well. In fact, they come with a range of options, including underskin, lifting strakes, hydraulic steering and even ladder options.

Our three-tube hulls provide unparalleled flexibility and options for your boating needs. Seeking maximum speed? We have you covered. Need the best maneuverability? You got it. Want a combination of style and performance? We can offer that too. Our selection allows you to personalize your boating experience with options such as "in-floor" storage, performance lifting strakes, power steering, or even telescoping ladders. The Bentley hull comes with a lifetime warranty for endless family fun, regardless of the option you choose to customize your boat.

XLP3 Hull

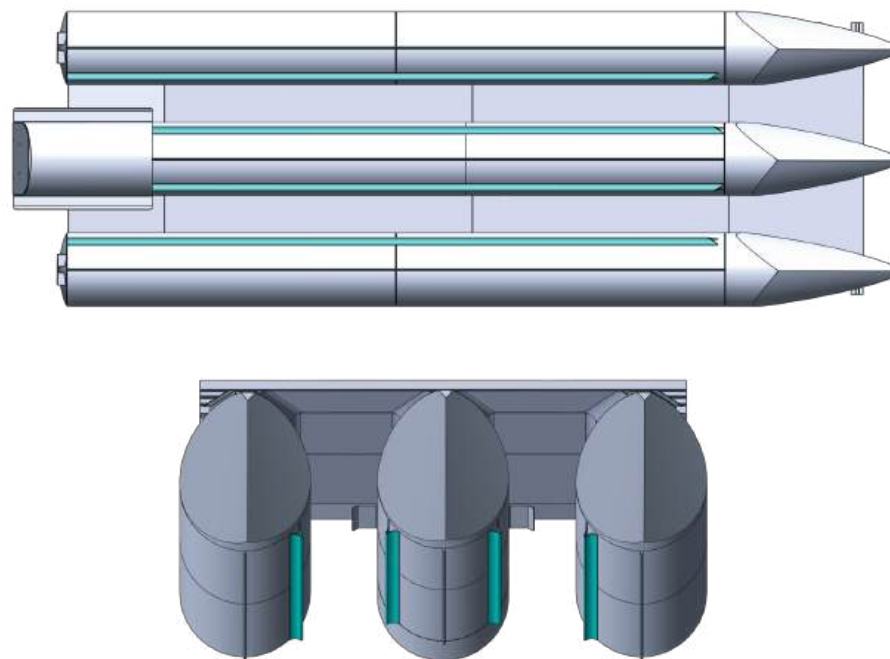

This Xtra Luxurious Performance Triple Toon provides the ultimate ride in boating. Choose this hull for rougher water sports or a comfortable cruise. The XLP3 hull is available on all series of boats except LE.

- (3) 25" diameter round tubes with a 25" shaft transom - STANDARD
- All welded aluminum transom with built-in 54-gallon fuel tank and "U-shaped" motor pod - STANDARD
- Aluminum underskin to increase speed, reduce turbulence, noise, and spray - STANDARD
- Lifting strakes strategically placed on the tube for "lift", speed, and less drag. - STANDARD
- 3/4" - 7-ply marine grade plywood with a lifetime warranty - STANDARD
- SeaStar Hydraulic steering - STANDARD
- Center tube "in-flooring" storage area for skis, water toys, etc. - OPTIONAL

SPORT3 Hull

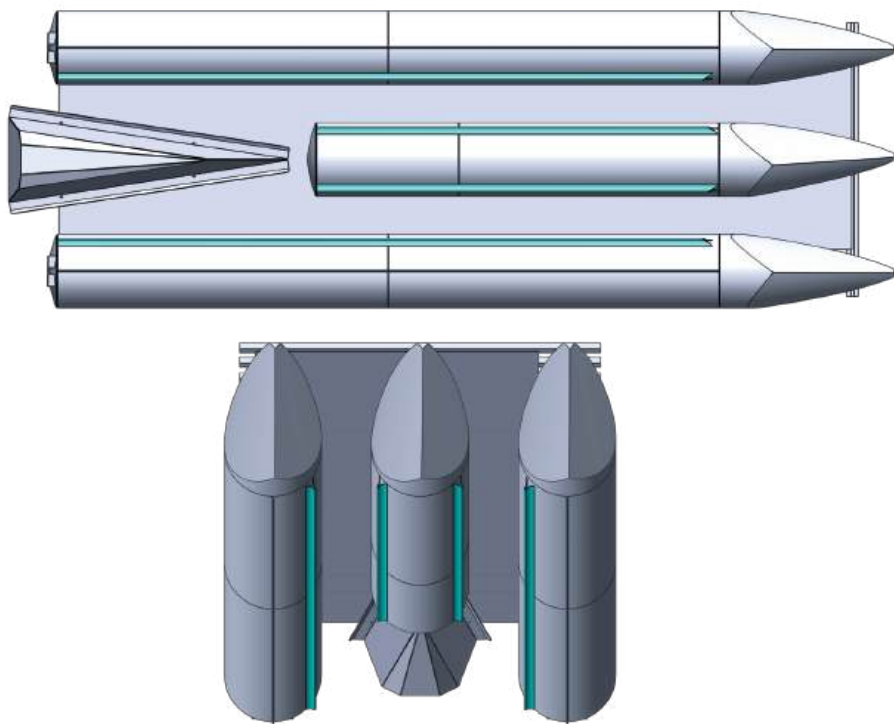

This agile High Performing Triple Toon provides great top-end speed. Its lighter weight enhances fuel economy and it has an economical price. Choose this hull for water sports, speed, and cruising. The SPORT3 hull is available on all series of boats except LE.

- (3) 25" diameter round tubes with a 20" shaft transom - STANDARD
- All welded aluminum transom with built-in 32-gallon fuel tank and "V-shaped" motor pod - STANDARD
- Aluminum underskin to increase speed, reduce turbulence, noise, and spray - STANDARD
- Lifting strakes strategically placed on the tube for "lift", speed, and less drag. - STANDARD
- 3/4" - 7-ply marine grade plywood with a lifetime warranty - STANDARD
- SeaStar Hydraulic steering - STANDARD
- Center tube "in-flooring" storage area for skis, water toys, etc. - OPTIONAL

2-Tube Hull

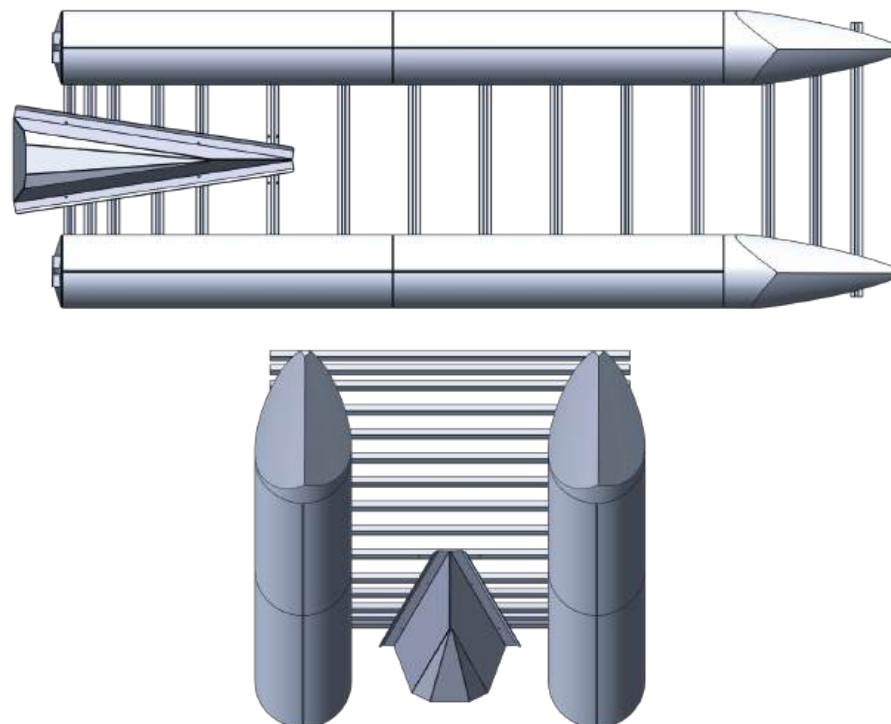

This proven, durable, hydrodynamic hull is a great all-around performer. Its rugged and safe design is trusted by all. Choose this hull for a relaxing cruise, entertaining, basic water sports, and comfort. The 2-tube hull is available on all models.

- (2) 25" diameter round tubes with a 20" shaft transom - STANDARD
- All welded aluminum transom with built-in 18 or 32-gallon fuel tank and "V-shaped" motor pod - STANDARD
- 3/4" - 7-ply marine grade plywood with a lifetime warranty - STANDARD
- Aluminum underskin to increase speed, reduce turbulence, noise, and spray - OPTIONAL
- Lifting strakes strategically placed on the tube for "lift", speed, and less drag. - OPTIONAL

The Bentley Warranty



The team at Bentley goes to great lengths to search out quality vendors who collaborate and work with us to assist in the creation of our boats. Because of this, we offer strong warranties on our decking, workmanship, and components for all our pontoon boats. For added peace of mind, we've included our warranty details in the QR code that you can scan.

Our warranties include:

- Limited Lifetime Structural Warranty
- Limited Lifetime Workmanship Warranty on Tubes
- 5-Year Limited Furniture Vinyl and Floor Covering Warranty
- 5-Year Limited Bimini and Mooring cover fabric
- 5-Year Limited Component Parts Warranty
- One-Time Warranty Transfer

Bentley Pontoons' comprehensive warranty policy provides peace of mind to current owners while enhancing resale value by offering long-term protection and reliability.

SCAN THE FOLLOWING QR
CODE FOR THE ENTIRE BENTLEY
LIMITED WARRANTY



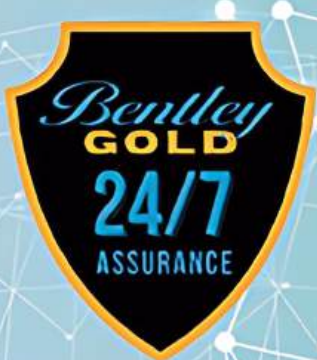

Powered by
BOATFIX

**Included
with all
Bentley
MY 2025
Pontoons**

24/7

**Boat
Monitoring**

**Live Customer
Support**

**Mechanical
Advisory
Helpline**



YOUR BENTLEY GOLD 24/7 ASSURANCE PLAN INCLUDES:



Battery Monitoring

Continuously tracks battery voltage for both high and low levels.



GPS Location

Monitor your boat's location anywhere, anytime.



24/7 Mechanical Advisory Helpline

Breakdown on the water? Call our advisors 24/7/365, and we'll get you back up and running. Video calls, too.



Theft Prevention With Protect Mode

Activate our Protect Mode and if your boat moves over 100 yards, you'll receive an alert and call from us.



Theft Recovery

Our theft recovery software assists authorities in tracking down your boat.



Insurance Approved

Our device may help you secure insurance or discounted rates.



Round-the-Clock Support

Our live operators based in US are available to assist you, anytime, 24/7, even on weekends and holidays. We will answer your call in seconds.



Mobile Application

We offer a consumer-friendly app for round-the-clock monitoring.



Scan to view video



Bentley

THE BEST VALUE IN BOATING



Bentley Pontoons



@bentleypontoons



@Bentley_Pontoons



Bentley Pontoons



@BentleyPontoons

www.bentleypontoons.com

1650 Two Notch Road Lexington, SC 29073